



Delux Courier - Basin & Pedestal

PRODUCT CODES

BASIN + PED:	XBPX08A	BASINBOXSET-B/LUX-WHI(COURIER)
COLOUR BOXED	XBPX**A	BASINBOXSET-B/LUX-WHI(COURIER)
WHITE BASIN:	WBDC0208A	BASIN-DELUX COURIER-W/HUNG-WHI
COLOUR BASIN:	WBDC02**A	BASIN-DELUX COURIER-W/HUNG-**
OVERFLOW:	TGWBROSE	TG-WASH BASIN OVERFLOW ROSETTE
WHITE PED:	PHX108A	PED-UNIVERSAL-WHI
COLOUR PED:	PHX**A	PED-UNIVERSAL-**
FIXATION:	FXWB0001	FIX-BASIN FIXATIONS

WALL HUNG BASIN, PEDESTAL, FLOOR MOUNTED WITH FIXATIONS

WEIGHT OF BASIN:	13.8 kg
WEIGHT OF PEDESTAL:	9.8 kg
BASIN WIDTH:	555 mm
BASIN LENGTH:	425 mm
BASIN DEPTH:	145 mm
PEDESTAL WIDTH:	175 mm
PEDESTAL HEIGHT:	630 mm
WASTE SIZE:	45 mm
OVERFLOW SIZE:	24 mm
CENTRE TAP DIAMETER:	35 mm
SIDE TAP DIAMETER:	31 mm
SIDE TAP DISTANCE:	200 mm
FIXATION HOLE DISTANCE:	280 mm



AVAILABLE COLOURS:



The Delux Courier basin is a wall-hung basin, with floor mounted pedestal.

DELUX COURIER BASIN & PEDESTAL INSTALLATION GUIDE:

1. Mark the position of the basin on the wall.
2. Screw the basin to the wall or hang it on the brackets depending on the type.
3. Connect the supply pipes to the taps.
4. Fit the trap to the basin waste.
5. The pedestal must be fitted under the basin to cover the plumbing at the end.

Then tighten basin fixation bolts last.

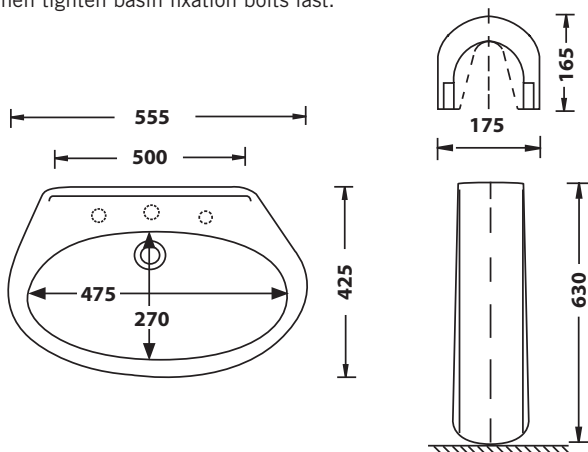

10
YEAR
WARRANTY

