

Geberit installation set with nipple made of brass, for urinal flush control, universal

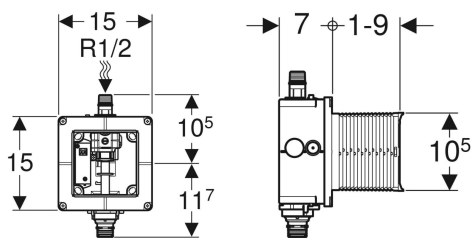

Example image



Application purposes

- For concealed installation in solid construction

Characteristics

- Water supply connection on the top centre
- Premounted conduit pipe for rinsing pipeline
- Premounted stop valve with throttle
- Electrical connection prepared

Scope of delivery

- Protection box with cover
- Water supply connection R 1/2"
- Concealed housing

- Protection box for service opening can be cut to length without tools

Technical data

Flow pressure	1-8 bar
Maximum test pressure, water	16 bar
Flow rate at 1 bar without flow limiter	0.3 l/s
Flow rate at 1 bar with flow limiter	0.24 l/s

- Stop valve with throttle
- Conduit pipe
- Terminal

Art. no.

116.004.00.1



- Not compatible with art. no. 115.817.xx.5 and 115.818.xx.5